

HIT PRODUCT CATALOGUE



EXCLUSIVELY DISTRIBUTED BY
TRIDON ▶

PROFESSIONAL TOOLS
HIT 

THE TOOLS PROFESSIONALS USE

HIT is one of the world's leading manufacturers of professional bolt cutters, rod cutters & benders and other hand tools.

HIT have been manufacturing tools in Japan for over 75 years to the highest possible standards ensuring premium quality products with a long service life.

Spare heads and blades are available to further extend the life of the tools.

HIT tools are made in Japan and distributed exclusively by Tridon throughout Australia.

For further information on HIT tools please contact Tridon Customer Service as listed on the back of this catalogue.



CONTENTS

	page
Standard Bolt Cutters [Black Jaw]	2
High Tensile Bolt Cutters [Red Jaw]	2
Heavy Duty High Tensile Bolt Cutters [Silver Jaw]	3
Angular Cutters	4
Threaded Rod Cutters	5
Rod Cutters & Benders	6
Swaging/Crimping Tools	6
Aluminium Hollow Wall Anchor Bolts	7
Hand Riveters	7
Concrete Mesh Cutters	7
Pruning Shears	8
Brush Cutters	8
Steel Strap Cutters	8
Pocket Cutters	9
Cable Cutters	9
Wire Rope Cutters	10
Belt Wrenches	11
Spud Wrenches	11
Pipe Wrenches	11
Merchandisers	12
Part Number Index	13

Definition of Metal Hardness

Hard Metals: Up to Brinell 370/Rockwell C40

Medium Hard Metals: Up to Brinell 300/Rockwell C31

Soft Metals: Up to Brinell 200/Rockwell C15

Medium Steel: HRC 35 114kg/mm²

Hard Steel: HRC 40 131kg/mm²

Extra Hard Steel: HRC 48 162kg/mm²

Safety Tips

- Use safety glasses and safety shoes when operating the cutter or when in the vicinity of another person using it
- Use the correct tool for the material. Do not exceed the rated capacity of the tool
- Keep the tool in a well oiled, safe, operating condition
- Cut with the jaws at a right angle to the material
- To minimise any flying metal wrap a cloth, rag or burlap around the cutter's jaws

Standard Bolt Cutters [Black Jaw]

- Recommended for general purpose use
- **Maximum hardness of material to be cut: Brinell 370/ Rockwell C40, 133kg/mm² or 85 tonnes/sq.in**
- Suitable for concrete reinforcing rods, medium tensile soft nuts and bolts
- Features include heat treated manganese vanadium steel jaws, adjusting bolts located at the jaw strap to keep cutting edges parallel during use and to provide better cutting performance
- Comfortable rubber handles for gripping firmly and safely

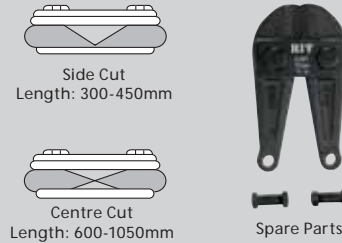

Type of Jaw	Part No.	Length	Weight	Cutting Capacity			Spare Parts	
				Soft Metal 49.6kg/mm ²	Hard Metal 133kg/mm ²	High Tensile 162kg/mm ²	Spare Head inc. Nuts & Bolts	Nuts & Bolts
		mm (inch)	kg	mm	mm	mm		
Side Cut	HITNBC0300	300 (12)	0.70	5	4		HITNBCC0300	BC12-SP01
	HITNBC0350	350 (14)	1.00	7	5		HITNBCC0350	BC14-SP01
	HITNBC0450	450 (18)	1.70	8	6		HITNBCC0450	BC18-SP01
Centre Cut	HITNBC0600	600 (24)	2.80	10	8		HITNBCC0600	BC24-SP01
	HITNBC0750	750 (30)	4.20	13	9		HITNBCC0750	BC30-SP01
	HITNBC0900	900 (36)	6.40	16	10		HITNBCC0900	BC36-SP01
	HITNBC1050	1050 (42)	8.60	19	11		HITNBCC1050	BC42-SP01

High Tensile Bolt Cutters [Red Jaw]

- Recommended for heavy duty use
- **Maximum hardness of material to be cut: Brinell 450, Rockwell C48, 162kg/mm² or 110 tonnes/sq.in.**
- Durable jaws are forged from high tensile alloy steel that is specially heat treated and suitable for cutting hard materials
- Short cutting edge to cut through chain links, high tensile bolts, rods and high tensile wire for pre-stressed concrete, etc
- Comfortable rubber handles for gripping firmly and safely

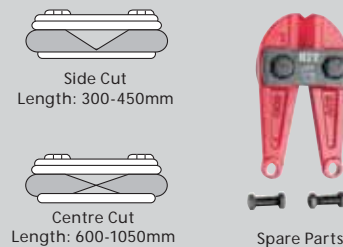

Type of Jaw	Part No.	Length	Weight	Cutting Capacity			Spare Parts	
				Soft Metal 49.6kg/mm ²	Hard Metal 133kg/mm ²	High Tensile 162kg/mm ²	Spare Head inc. Nuts & Bolts	Nuts & Bolts
		mm (inch)	kg	mm	mm	mm		
Side Cut	HITNBC0300H	300 (12)	0.70	5	4		HITNBCC0300H	BC12-SP01
	HITNBC0350H	350 (14)	1.00	7	5		HITNBCC0350H	BC14-SP01
	HITNBC0450H	450 (18)	1.70	8	6	5.5	HITNBCC0450H	BC18-SP01
Centre Cut	HITNBC0600H	600 (24)	2.80	10	8	7	HITNBCC0600H	BC24-SP01
	HITNBC0750H	750 (30)	4.20	13	9	8	HITNBCC0750H	BC30-SP01
	HITNBC0900H	900 (36)	6.40	16	10	9	HITNBCC0900H	BC36-SP01
	HITNBC1050H	1050 (42)	8.60	19	11	10	HITNBCC1050H	BC42-SP01

Heavy Duty High Tensile Bolt Cutters [Silver Jaw]

- Recommended for constant, extra heavy duty use eg. production line applications
- **Maximum hardness of material to be cut: Brinell 450/ Rockwell C48, 162kg/mm² or 110 tonnes/sq.in**
- These high tensile silver jaw cutters have a short, high tempered jaw edge with extra treatment on the cutting edge. As a result, the silver jaw cutter provides exceptional strength and durability.
- Suitable for cutting concrete reinforcement mesh and for production line use, and for any constant work where longevity of the tool is required
- Comfortable rubber handles for gripping firmly and safely

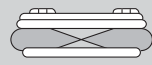

Centre Cut
All sizes



Spare Parts



High tempered jaw with extra treatment on the cutting edge



Type of Jaw	Part No.	Length	Weight	Cutting Capacity			Spare Parts	
				Soft Metal 49.6kg/mm ²	Hard Metal 133kg/mm ²	High Tensile 162kg/mm ²	Spare Head inc. Nuts & Bolts	Nuts & Bolts
		mm (inch)	kg	mm	mm	mm		
Centre Cut	HITNBC0600S	600 (24)	2.80	10	8	7	HITNBCC0600S	BC24-SP01
	HITNBC0750S	750 (30)	4.20	13	9	8	HITNBCC0750S	BC30-SP01
	HITNBC0900S	900 (36)	6.40	16	10	9	HITNBCC0900S	BC36-SP01
	HITNBC1050S	1050 (42)	8.60	19	11	10	HITNBCC1050S	BC42-SP01

Angular Cutters

- Angular jaws with side cut blades which have a 30° offset to keep work in view and hands clear of work surface while cutting
- **Maximum hardness of material to be cut: Brinell 370/ Rockwell C40, 85 tonnes/sq.in. 133kg/mm²**
- Cuts medium and soft material
- Designed for flat (flush) cutting of wire in concrete walls, ceilings, floors etc
- Comfortable rubber grip handles for gripping firmly and safely
- Spare heads available

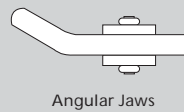
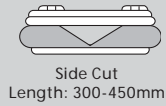

Part No.	Length mm (inch)	Weight kg	Cutting Capacity		Spare Parts Part No.
			49.6kg/mm ² mm	133kg/mm ² mm	
HITAC350	350 (14)	1.00	7	5	HITACC350
HITAC450	450 (18)	1.70	8	6	HITACC450
HITAC600	600 (24)	2.80	10	7	HITACC600

Bolt Cutters - Adjustment of cutting edge

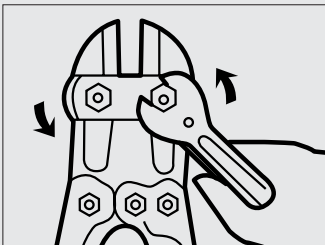

1. Loosen nuts on cam bolts about one round (360°)

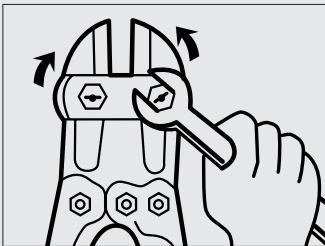

2. Align cutter jaws by rotating the cam bolts; move arrows on cam bolt inward to close jaw

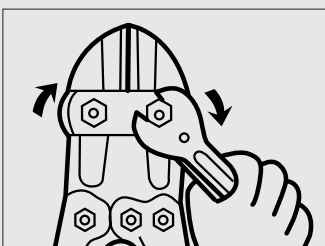

3. Tighten nuts

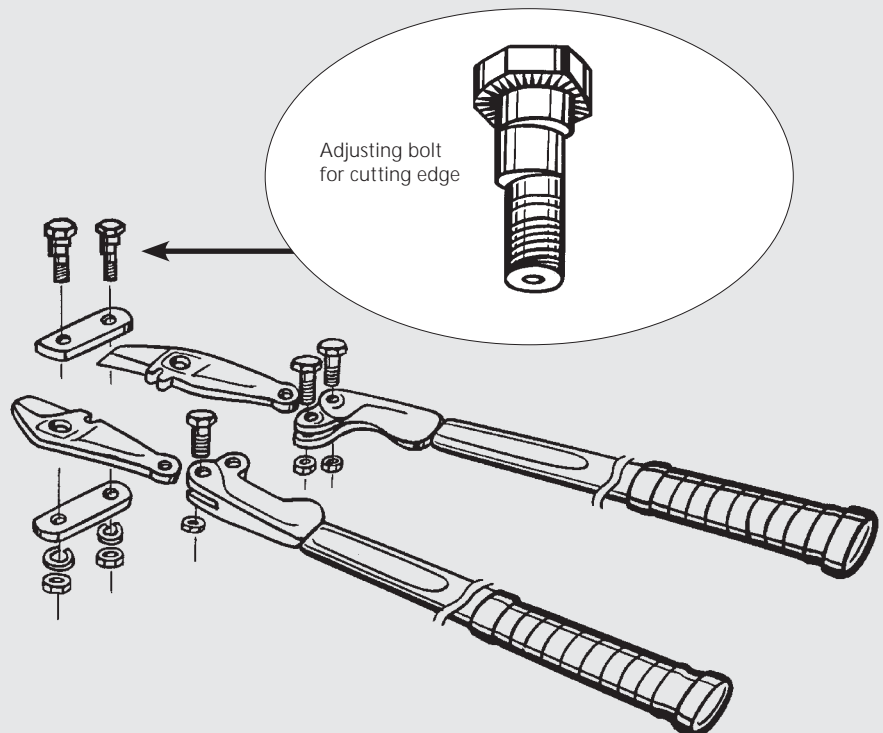

Threaded Rod Cutters

- A must for construction sites where threaded rods are used to secure pipe, conduit sprinkler systems, ductwork, lighting, ceiling and many other construction applications
- Cuts fast, clean, with precision and eliminates grinding, filing and thread restoring
- Forged alloy steel head with heat-treated cutting dies
- Mounting holes for permanent mounting to work surface
- Lasts up to 3000 cuts, life of the die can be extended by changing to alternate side
- Interchangeable dies available for metric and inch
- Lightweight and easy to use

Single Head

Dies available to suit 6mm, 8mm, 10mm, 1/4", 5/16", 3/8" soft steel threaded rods

Double Head

Double head to suit 10mm & 12mm or 1/2" & 3/8" soft steel threaded rods



Single Head

Double Head

Die and Screw Set

Style	Part No.	Length		Weight	Capacity	
		mm	(inch)		Diameter	Pitch
Single Head	HITTRC6	740	(29)	4.14	6mm	1.00
	HITTRC8	740	(29)	4.14	8mm	1.25
	HITTRC10	740	(29)	4.14	10mm	1.50
	HITTRC1/4	740	(29)	4.14	1/4"	20 tpi
	HITTRC5/16	740	(29)	4.14	5/16"	18 tpi
	HITTRC3/8	740	(29)	4.14	3/8"	16 tpi
Double Head	HITTRC1238	850	(33)	7.00	1/2"	13 tpi
					3/8"	16 tpi
	HITTRC1210	850	(33)	7.00	10mm	1.50
					12mm	1.75

Die & Screw Sets	
Spare Part No.	Diameter
HITTRCC6	6mm
HITTRCC8	8mm
HITTRCC10	10mm
HITTRCC1/4	1/4"
HITTRCC5/16	5/16"
HITTRCC3/8	3/8"
HITTRCC1/2	1/2"
HITTRCC3/8	3/8"
HITTRCC10	10mm
HITTRCC12	12mm

Rod Cutters & Benders

- Unique two in one combination tool, designed for cutting and bending of concrete reinforcing rods up to 180°
- Drop forged, heat treated jaws made from high grade alloy steel
- Shear cut blades cut and bend 60 rebar to 90° or 180°
- Can be bolted to floor or board for easy one-hand operation
- Spare heads available

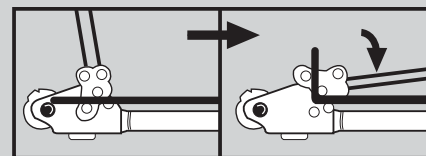

90° Bend

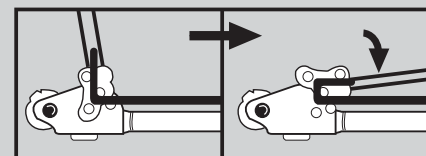

135°- 180° Bend

Part No.	Length	Max Capacity mm	Weight kg	Spare Heads	
	mm (inch)			Part No.	
HITRC13B	1070 (1/2)	13	10.5	HITRCC13BL	
HITRC16B	1320 (5/8)	16	16.0	HITRCC16BL	

Swaging/Crimping Tools

- Designed for swaging / crimping copper or aluminium swages
- Forged alloy steel, heat treated jaws designed to produce a tight, clean compression of copper and aluminium swages
- Available in Crimp & Wire Rope Cutter or Crimp only

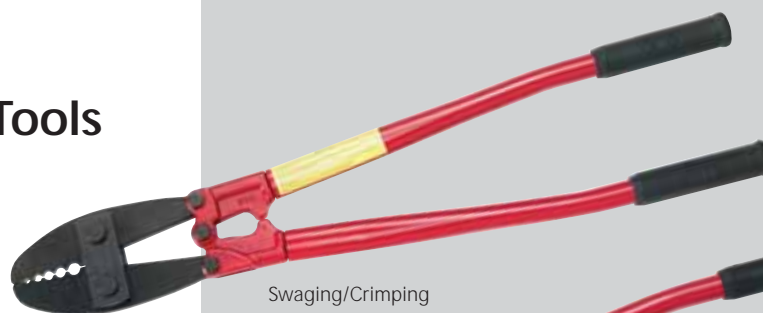

Swaging/Crimping

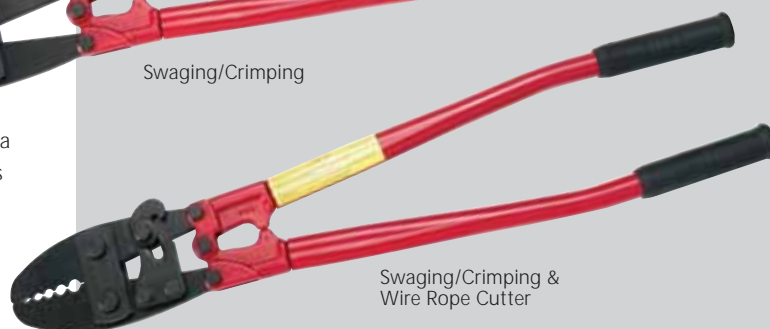

Swaging/Crimping & Wire Rope Cutter

Style	Part No.	Length	Weight kg	Crimping Capacities		Cutting Wire Rope Capacity	Spare Heads Part No.
		mm (inch)		mm	(inch)		
Swaging/Crimping	HITCT350/3	350 (14)	1.06	1.5, 2.5, 3mm	(1/16", 3/32", 1/8")	-	HITCTC350/3
	HITCT600/5	600 (24)	2.95	1.5, 2.5, 3, 4, 5mm	(1/16", 3/32", 1/8", 5/32", 3/16")	-	HITCTC600/5
	HITCT750/3	750 (30)	4.23	4, 6, 8mm	(5/32", 1/4", 5/16")	-	HITCTC750/3
	HITCT900	900 (36)	6.12	10mm	(3/8")	-	HITCTC900
Swaging/Crimping & Wire Rope Cutter	HITCT350/3C	350 (14)	1.13	1.5, 2.5, 3mm	(1/16", 3/32", 1/8")	1/8"	HITCTC350/3C
	HITCT600/5C	600 (24)	3.06	1.5, 2.5, 3, 4, 5mm	(1/16", 3/32", 1/8", 5/32", 3/16")	1/4"	HITCTC600/5C
	HITCT750/3C	750 (30)	4.54	4, 6, 8mm	(5/32", 1/4", 5/16")	5/16"	HITCTC750/3C

Aluminium Hollow Wall Anchor Bolts

- Can be used when it is difficult to use normal fixings, yet it is desirable to withdraw and replace a screw at the wall
- Ideal for use in all kinds of hard or soft wall boards, plastic and hollow bricks, tiles etc
- Sold in packs of 200



Part No.	Flange Dia.	Flange Length	Drill Hole Dia.	Fastening Plate Thick.	Hold Capacity
HITAB4M	6mm	30mm	6.5mm	10mm	95kg

Hand Riveters

- Strong iron hand for heavy duty work
- Comes with 4 interchangeable screw-in nose for rivet sizes: 3/32", 1/8", 5/32", and 3/16"
- Features spring loaded handle with nose wrench



HITHR001



HITHR008



HITHR003

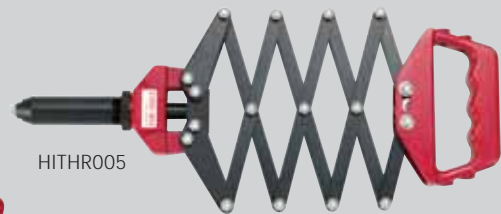

HITHR005

Part No.	Length (mm)	Capacity (mm)	Weight (kg)
HITHR001	260	2.4 / 3.2 / 4.0 / 4.8	0.65
HITHR008	235	2.4 / 3.2 / 4.0 / 4.8	0.45
HITHR003	450	3.2 / 4.0 / 4.8	1.50
HITHR005	310	3.2 / 4.0 / 4.8	1.50

Concrete Mesh Cutters

- Specially designed for cutting concrete mesh
- Maximum hardness of material to be cut: Brinell 450/Rockwell C48/162kg/mm²
- Centre cut
- Comfortable rubber handles for gripping firmly and safely
- Spare heads available



Part No.	Length mm (inch)	Weight kg	Cutting Capacity		Spare Heads Part No.
			49.6kg/mm ² mm	162kg/mm ² mm	
HITRCA800	800 (33)	3.15	10	8	HITRCAC800

Pruning Shears

- Suitable for all pruning work
- Light aluminium handles with comfortable grip, fast and simple blade adjustment.
- Ideal for vineyards, nurseries, councils and general gardening specialists
- Replacement blades available

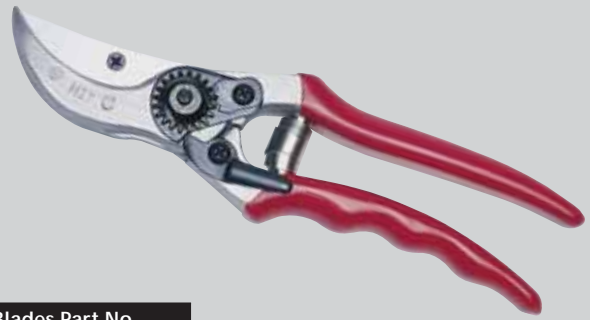

Part No.	Length	Weight	Spare Blades Part No.
HITMPS11	215mm	240g	HITMPSK100

Brush Cutters

- Heavy duty - 40mm cutting capacity
- Heat treated drop forged blades made with high grade alloy steel. Light weight handles made of heat treated spring steel
- Designed for cutting greenwood, PVC pipe, rubber hose and other non-metal soft material
- Cutting head folds completely inside handle for safe, hands free use prior to climbing ladders
- Comfortable rubber grip handles



Part No.	Length	Greenwood
HITBRC27	675mm	40mm

Steel Strap Cutters

- Drop forged alloy steel blades with heat treatment
- Blades have black oxide, rust resistant finish
- Shear cut blades give a clean, smooth and easy cut - excellent for pallets, loading and unloading cars, trucks, ship and metal recycling yards



HITSS200

HITSS450

HITSS600

Part No.	Length	Max. Cutting Capacity	Weight
HITSS200	200mm	32mm x 0.9mm	0.3kg
HITSS450	450mm	51mm x 1.2mm	1.4kg
HITSS600	600mm	51mm x 1.3mm or 32mm x 1.2mm x double	2.7kg

Pocket Cutters

- Light weight, general purpose
- Special alloy hardened and tempered cutting blade
- Comfortable grip with spring action permitting one hand operation
- Lockable handles

Part No.	Description	Length	Max. Cutting Capacity		
			Mild Steel Brinell 140	Hard Steel Brinell 370	Piano Wire Brinell 410
		mm	mm	mm	mm
HITPC200	Hand Cutter	200	4	2	-
HITPE200	End Cutter	200	3.5	2	-
HITPH200	Wire Cutter	200	4	3	2.5



Hand Cable Cutters

- Shear-cut blades, jaws designed for cutting copper and aluminium cable
- Vinyl grip handles (not insulated)

Part No.	Length	Max. Cutting Capacity		Outside Diameter
		Copper IV Cable	Copper WCT Cable	
HITSC10	160mm	22mm ²	50mm ²	9.2mm
		30mm ²	60mm ²	10.5mm
HITSC20	210mm	38mm ²	90mm ²	11.5mm
		30mm ²	60mm ²	21.0mm
HITSC30	240mm	38mm ²	90mm ²	11.5mm
		30mm ²	60mm ²	24.0mm



* Not for cutting ACSR, wire rope, steel or self supporting strand

Cable Cutters

- Forged alloy tool steel jaws, shear cut blades give sharp, clean cut with minimal distortion
- Cuts soft, non-steel cable such as lead and rubber covered aluminium and copper cable
- Comfortable rubber grip handles
- Spare heads available



Part No.	Length	Weight	Max. Cutting Capacity		Outside Diameter	Spare Heads Part No.
HITSC250R	600mm	1.78kg	Aluminium Cable	600MCM (350mm ²)	33mm	HITSCC250H
			Copper Cable	350MCM (250mm ²)		
HITSC500R	830mm	4.00kg	Aluminium Cable	1000MCM (650mm ²)	50mm	HITSCC500H
			Copper Cable	500MCM (300mm ²)		

* Not for cutting ACSR, wire rope, steel or self supporting strand

Wire Rope Cutters



- Designed for cutting soft and hard cable, wire rope, ACSR cable
- Shear-cut blades give clean, sharp cut

Part No.	Length	Weight	Max. Cutting Capacity		
	mm		kg	Copper Aluminum	Wire Rope
HITW16	710	2.2	250mm ²	16mm Dia	120mm ²

Hand Wire Rope Cutters



- Designed for cutting all soft and hard steel cable and wire

Part No.	Length	Weight	Max. Cutting Capacity		
	mm		kg	Wire Rope	Piano Wire
HITHWC06	190	0.31	6mm	2.5mm	4mm

Heavy Duty Wire Rope Cutters



- Designed for cutting wire rope, piano wire, steel wire, ACSR cable and aircraft cable
- Forged aluminium handles

Part No.	Length	Weight	Max. Cutting Capacity			
	mm		kg	Wire Rope	Piano Wire	Steel Wire
HITHWC09	335	0.71	9mm	4.0mm	6mm	25mm ²
HITHWC12	520	1.50	12mm	4.5mm	7mm	58mm ²
HITHWC16	650	2.50	16mm	5.0mm	9mm	120mm ²

Wire Rope Cutters with Cable Locator

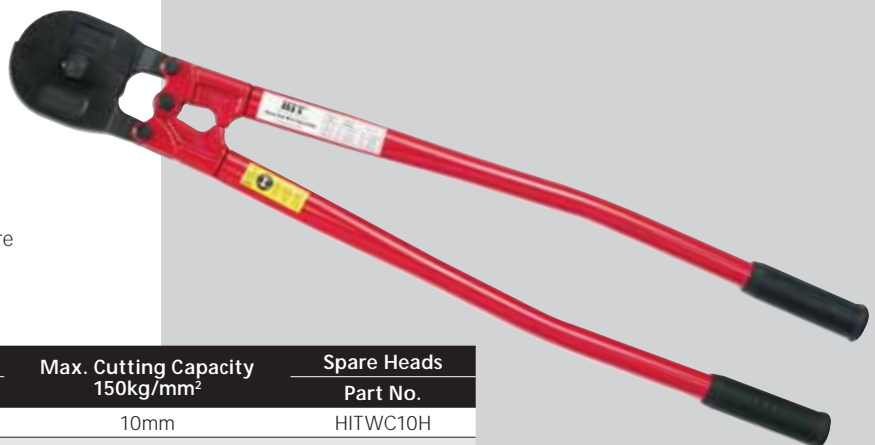

- Super heavy duty
- Designed for cutting wire rope up to 150kg/mm²
- Notched shear cut blade
- Holds and locks cable in cutting position to ensure a clean, sharp cut
- Spare heads available

Part No.	Length	Weight	Max. Cutting Capacity 150kg/mm ²	Spare Heads
	mm			kg
HITWC10	600	2.30	10mm	HITWC10H
HITWC14	750	3.85	14mm	HITWC14H
HITWC16	900	5.50	16mm	HITWC16H
HITWC20	1050	8.50	20mm	HITWC20H

Belt Wrench with Rubber-Impregnated Belt

- Grip and turn even polished pipes such as stainless steel pipes, coated pipes or coloured pipes without abrasion on the surface
- Flexible, heavy duty rubber-impregnated nylon belt



Part No.	Length	Belt Width	Belt Length	Pipe Size
	mm (inch)	mm	mm	inch
HITBTW6G	300 (12)	31	700	6

Adjustable Spud Wrench

- Lightweight, die cast aluminium alloy construction (weighs only 240 grams)
- Excellent for working on plumbing, water filters, PVC conduits and polished shafts
- Suitable for working in confined spaces and difficult areas
- Durable, soft jaw pads to protect work from marring
- Ideal for using on polished, chrome plated or brass tubular fittings as it protects against scratches, damage or deformity



Part No.	Length	Max. Opening
	mm (inch)	mm
HITAOM68	200 (8)	16-68

Straight Pipe Wrenches

- Drop forged steel with alloy steel body, chrome jaws
- Heat treated for extra strength and durability
- The frame is made from the same block as the handle. Hook jaw with spring suspension for quick grip and release



Part No.	Length	Pipe Size	Max. Opening
	mm (inch)	inch	mm
HITPD08	200 (8)	1	34
HITPD10	250 (10)	1-1/4	51
HITPD12	300 (12)	1-1/2	58
HITPD14	350 (14)	2	69
HITPD18	450 (18)	2-1/2	80
HITPD24	600 (24)	3	95
HITPD36	900 (36)	4	132

Aluminium Pipe Wrenches

- Toughened steel, drop forged
- Movable jaw surrounds with coarse knurled adjusting nut
- Wide and smooth teeth for vinyl coated pipe
- Hook jaw with spring suspension for quick grip and release
- Lightweight



Part No.	Length	Pipe Size	Max. Opening
	mm (inch)	inch	mm
HITALP250S	250 (10)	1-1/4	48
HITALP300S	300 (12)	1-1/2	60
HITALP350S	350 (14)	2	72
HITALP450S	450 (18)	2-1/2	86
HITALP600S	600 (24)	3	105
HITALP900S	900 (36)	4	150

Corner Pipe Wrenches

- Drop forged and ideal for piping construction in narrow and crowded places
- Easily fits on and off pipes due to the spring loaded head
- Internal adjusting jaw, opens parallel to handle

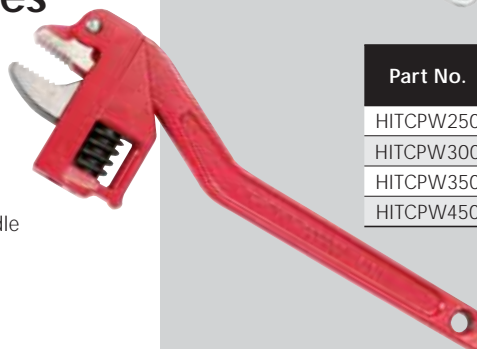

Part No.	Length	Pipe Size	Max. Opening
	mm (inch)	inch	mm
HITCPW250	250 (10)	1	35
HITCPW300	300 (12)	1-1/4	44
HITCPW350	350 (14)	1-1/2	51
HITCPW450	450 (18)	2	70

Merchandisers

- Sturdy powder coated metal frame with extra strong hooks, can be wall mounted, freestanding or incorporated into your planogram
- Each merchandiser contains six bolt cutters, one pocket cutter and one wire rope cutter
- All part numbers and spare parts can be purchased individually
- Available for **standard black jaw** or **high tensile red jaw** bolt cutters
- Dimensions: W)950 x H)910 x D)270mm

Standard Bolt Cutters [Black Jaw series]

Part No. HBCM01

Contents

Part No.	Length mm (inch)	Description
HITNBC900	900 (36)	Standard Bolt Cutter
HITNBC750	750 (30)	Standard Bolt Cutter
HITNBC600	600 (24)	Standard Bolt Cutter
HITNBC450	450 (18)	Standard Bolt Cutter
HITNBC350	350 (14)	Standard Bolt Cutter
HITNBC300	300 (12)	Standard Bolt Cutter
HITPC200	200 (8)	Pocket Cutter
HITHWC06	190 (7.5)	Wire Rope Cutter



High Tensile Bolt Cutters [Red Jaw Series]

Part No. HBCM02

Contents

Part No.	Length mm (inch)	Description
HITNBC900H	900 (36)	High Tensile Bolt Cutter
HITNBC750H	750 (30)	High Tensile Bolt Cutter
HITNBC600H	600 (24)	High Tensile Bolt Cutter
HITNBC450H	450 (18)	High Tensile Bolt Cutter
HITNBC350H	350 (14)	High Tensile Bolt Cutter
HITNBC300H	300 (12)	High Tensile Bolt Cutter
HITPC200	200 (8)	Pocket Cutter
HITHWC06	190 (7.5)	Wire Rope Cutter



PART NUMBER INDEX

Part No.	Page
HBCM01	12
HBCM02	12
HITAB4M	7
HITAC350	4
HITAC450	4
HITAC600	4
HITALP250S	11
HITALP300S	11
HITALP350S	11
HITALP450S	11
HITALP600S	11
HITALP900S	11
HITAOM68	11
HITBRC27	8
HITBTW6G	11
HITCPW250	11
HITCPW300	11
HITCPW350	11
HITCPW450	11
HITCT350/3	6
HITCT350/3C	6
HITCT600/5	6
HITCT600/5C	6
HITCT750/3	6
HITCT750/3C	6
HITCT900	6
HITHR001	7
HITHR003	7
HITHR005	7

Part No.	Page
HITHR008	7
HITHWC06	10
HITHWC09	10
HITHWC12	10
HITHWC16	10
HITMPS11	8
HITNBC0300	2
HITNBC0300H	2
HITNBC0350	2
HITNBC0350H	2
HITNBC0450	2
HITNBC0450H	2
HITNBC0600	2
HITNBC0600H	2
HITNBC0600S	3
HITNBC0750	2
HITNBC0750H	2
HITNBC0750S	3
HITNBC0900	2
HITNBC0900H	2
HITNBC0900S	3
HITNBC1050	2
HITNBC1050H	2
HITNBC1050S	3
HITPC200	9
HITPD08	11
HITPD10	11
HITPD12	11
HITPD14	11

Part No.	Page
HITPD18	11
HITPD24	11
HITPD36	11
HITPE200	9
HITPH200	9
HITRC13B	6
HITRC16B	6
HITRCA800	7
HITSC10	9
HITSC20	9
HITSC30	9
HITSC250R	9
HITSC500R	9
HITSS200	8
HITSS450	8
HITSS600	8
HITTRC1/4	5
HITTRC5/16	5
HITTRC3/8	5
HITTRC6	5
HITTRC8	5
HITTRC10	5
HITTRC1210	5
HITTRC1238	5
HITW16	10
HITWC10	10
HITWC14	10
HITWC16	10
HITWC20	10



For further information contact

Tridon Customer Service:

Phone: 1300 362 263

Fax: 1300 656 006

Email: sales@tridon.com.au

www.tridon.com.au

AUSTRALIA

New South Wales

Head Office

15-27 Derby Street

Silverwater NSW 2128

Victoria

47 Glenvale Crescent

Mulgrave VIC 3170

Queensland

Unit 7/37 Northlink Place

Virginia QLD 4014

South Australia

9/422 Torrens Road

Kilkenny SA 5009

Western Australia

2/6 Holder Way

Malaga WA 6090

EXCLUSIVELY DISTRIBUTED BY

TRIDON 

CAT008 © Copyright TRIDON AUSTRALIA PTY. LTD. 2007

A.C.N. 001 398 698 Reproduction of this catalogue in part or full is not permitted without written approval. Illustrations in this catalogue are for identification purposes only and there may be slight variations between the illustration and actual product. Whilst every effort has been made to ensure that the information contained in this catalogue is accurate at the time of printing, TRIDON AUSTRALIA PTY LTD will not accept responsibility should any inaccuracies be contained herein.