

808050S-18 / 808050S-22

## Stubby ratchet bit screwdriver sets



### 808050S-18 18 pcs

18 pcs stubby ratchet bit screwdriver set  
 Contents: 1 pc stubby ratchet bit screwdriver  
 8 pcs zinc phosphate bits: PH1, PH2, PZ1, PZ2, T15, T20, SL 4, HEX 3  
 1 pc 1/4"x1/4" socket adaptor  
 1 pc 1/4" sq. x1/4" hex bit holder 50 mm (changeable type)  
 1 pc 1/4" sq. x 1/4" sq. flexible socket adaptor 150 mm  
 1 pc 1/4"x 1/4" bit adaptor  
 5 pcs 1/4" sockets: 4, 5, 6, 7, 8 mm



Box size (mm)  
 195W x 130D x 46H

### 808050S-22 22 pcs

22 pcs stubby ratchet bit screwdriver set  
 Contents: 1 pc stubby ratchet bit screwdriver  
 17 pcs zinc phosphate bits: PH1, PH2, PH3, PZ1, PZ2, T10, T15, T20, T25, T27, T30, T40, SL 4, SL 5, SL 5.5, SL 6.5, SL 1/4"  
 1 pc 1/4"x1/4" socket adaptor  
 1 pc 1/4" sq. x1/4" hex bit holder 50 mm (changeable type)  
 1 pc 1/4" sq. x 1/4" sq. flexible socket adaptor 150 mm  
 1 pc 1/4"x 1/4" bit adaptor



# Ratchet and bits SCREWDRIVERS



Product code	Description		EAN	Pack quantity
808050	Ratchet bit screwdriver Contents: PH1, PH2, PZ1, PZ2, SL4.5 and 5.5	⊕ ⊕ ⊖	7314153017642	1
808050L	Ratchet bit screwdriver with LED Contents: PH1, PH2, PZ1, PZ2, SL4.5 and 5.5	⊕ ⊕ ⊖	7314150128075	1
808050P	Pistol handle ratchet bit screwdriver Contents: PH1, PH2, PZ1, PZ2, SL4.5 and 5.5	⊕ ⊕ ⊖	7314150128105	1
808050A	Bit holder screwdriver * Contents: PH1, PH2, PZ1, PZ2, SL4.5 and 5.5	⊕ ⊕ ⊖	7314150127306	1
808050TORX * no ratchet mechanism	Bit holder screwdriver Torx * Contents: T10, T15, T20, T25, T30 and T40	⊕	7314150127313	1
808050TS * no bits storage	Stubby T-handle ratchet bit screwdriver *	⊕ ⊕ ⊖	7314150128099	1
808050S * no bits storage	Stubby ratchet bit screwdriver *	⊕ ⊕ ⊖	7314150128082	1
808050S-18	18 pcs stubby ratchet bit screwdriver set	⊕ ⊕ ⊖ ⊕ ⊖	7314150128921	1
808050S-22	22 pcs stubby ratchet bit screwdriver set	⊕ ⊕ ⊖ ⊕	7314150128938	1

B&C-0507-INT

SNA Europe



www.bahco.com



## NEW RANGE OF RATCHET AND BIT SCREWDRIVERS

Bahco is proud to introduce a new full range of ratchet and bit screwdrivers. Exclusive product features such as 48 teeth ratchet function, the super grip two-component handle, the cartridge bit storage and the led light function make your work easier and more efficient. All products have the same distinctive Bahco look, a design that stands out from the crowd.

**Easy to use**

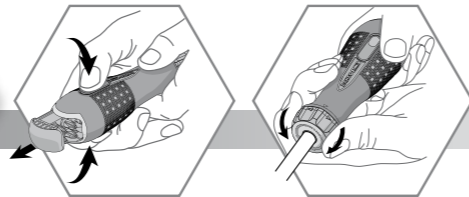

**808050**

### Ratchet bit screwdriver

Contents: PH1, PH2, PZ1, PZ2, SL4.5 and SL5.5

**Efficient magnetic device**  
1/4" magnetic bit holder

**Strength and reliability**  
Alloy steel shank

**Superior torque**  
Quality mechanism ensures high torque bearing capacity

**Easy to use**  
Self explanatory push buttons

**Comfort and strength**  
Oval handle shape with high friction surface for increased torque and comfort

**Three modes of operation**  
Reversing ring for quick mode selection. Clockwise, counter clockwise and non-ratchet (fixed) modes

**Faster spinning feature**  
Knurled part for fast spinning

**Bit storage**  
Cartridge style bit holder stores 6 bits

**808050L**

### Led light ratchet bit screwdriver

Contents: PH1, PH2, PZ1, PZ2, SL4.5 and SL5.5

**Efficient magnetic device**  
1/4" magnetic bit holder

**Strength and reliability**  
Alloy steel shank

**Superior torque**  
Quality mechanism ensures high torque bearing capacity

**Three modes of operation**  
Reversing ring for quick mode selection. Clockwise, counter clockwise and non-ratchet (fixed) modes

**Comfort and strength**  
Oval handle shape with high friction surface for increased torque and comfort

**Faster spinning feature**  
Knurled part for fast spinning

**Easy to use**  
Self explanatory push buttons

**Bit storage**  
Cartridge style bit holder stores 6 bits

Long-lasting LED lights mounted in front casing provide illumination in dark conditions

3 batteries LR41 & 2 lights AG-3 4.5V Included

**808050P**

### Pistol handle ratchet bit screwdriver

Contents: PH1, PH2, PZ1, PZ2, SL4.5 and SL5.5

**Strength and reliability**  
Alloy steel shank

**Superior torque**  
Quality mechanism ensures high torque bearing capacity

**Three modes of operation**  
Reversing ring for quick mode selection. Clockwise, counter clockwise and non-ratchet (fixed) modes

**Efficient magnetic device**  
1/4" magnetic bit holder

**Comfort and strength**  
Oval handle shape with high friction surface for increased torque and comfort

**Faster spinning feature**  
Knurled part for fast spinning

**Easy to use**  
Self explanatory push buttons

**Pistol mode**  
Handle swivels and locks at pistol position for application of higher torque

**Normal position**

**Bit storage**  
Cartridge style bit holder stores 6 bits

**Pistol mode release button**

**Pistol position**

**808050A / 808050TORX**

### Bit holder screwdrivers

Contents A: PH1, PH2, PZ1, PZ2, SL4.5 and SL5.5

Contents TORX: T10, T15, T20, T25, T30 and T40

**Strength and reliability**  
Alloy steel shank

**Efficient magnetic device**  
1/4" magnetic bit holder

**Faster spinning feature**  
Knurled part for fast spinning

**Easy to use**  
Self explanatory push buttons

**Comfort and strength**  
Oval handle shape with high friction surface for increased torque and comfort

**Bit storage**  
Cartridge style bit holder stores 6 bits

**808050TS**

### Stubby T-handle ratchet bit screwdriver high torque

**Three modes of operation**  
Reversing ring for quick mode selection. Clockwise, counter clockwise and non-ratchet (fixed) modes

**Strength and reliability**  
Alloy steel shank

**Superior torque**  
Quality mechanism ensures high torque bearing capacity

**Efficient magnetic device**  
1/4" magnetic bit holder

**Comfort and strength**  
Comfortable offset T-handle for maximum force, torque and comfort

**808050S**

### Stubby ratchet bit screwdriver easy reach

**Three modes of operation**  
Reversing ring for quick mode selection. Clockwise, counter clockwise and non-ratchet (fixed) modes

**Strength and reliability**  
Alloy steel shank

**Superior torque**  
Quality mechanism ensures high torque bearing capacity

**Efficient magnetic device**  
1/4" magnetic bit holder

**Reach and easy access**  
Compact handle for access to confined spaces